

Warranty

- The Australian warranty for the Chasing DTC Pro robotic pool cleaner covers manufacturer's defects in materials and workmanship for:
 - 3 years on the main body, PCBA, power supply and adapter, floating cable, power cord and indicator light
 - 2 years on drive motor and pump motor
 - 12 months on filter basket, track and roller brush

If the product is used in a commercial setting, all warranty periods are 12 months.

- The warranty is only valid for the original purchaser and is nontransferable.
 - Adverse operating conditions beyond the control of the manufacturer such as improper voltage, excessive ambient temperature or any condition that adversely affects the performance of the equipment will render this warranty null and void.
 - Defective equipment must be returned to the authorised dealer as soon as the purchaser becomes aware of the defect and all transport costs must be prepaid.
 - Neither the manufacturer nor the authorised dealer shall be responsible for any goods damaged in transit.
 - Any liability of the manufacturer pursuant to the Trade Practices Act 1974, as amended for a breach of a condition or warranty shall be limited to replacing or acquiring the equipment (or part thereof) where the same has been supplied.
 - The maximum liability incurred by the manufacturer shall not in any case exceed the contract price for the equipment or the product parts or components thereof claimed to be defective. Further, the manufacturer shall not be liable for any loss, damage or delay directly or indirectly caused by any malfunction of or defect of or failure of the equipment other than as expressly provided in this warranty.
 - The manufacturer and authorised dealer will not be held liable for damage caused to the pool surface and coping materials.
 - Keep your original purchase invoice and serial number in a safe place.
- Warranty is void under the following circumstances:
- Incorrect operation of the unit by not following correct instructions.
 - Improper maintenance and balancing of pool water.
 - Damage caused to the robot due to misuse or damage caused by any other means than manufacturer defect.
 - If the robot is repaired or serviced by an unauthorised dealer or serviceman.
 - If a fault occurs in the operation of the machine by using non-genuine accessories.
 - If the robot has been misused, neglected, damaged or altered in any way.
 - To submit a warranty request, visit www.poolpro.com.au/serviceclaim.

CHASING Hydro 6

EN User Manual

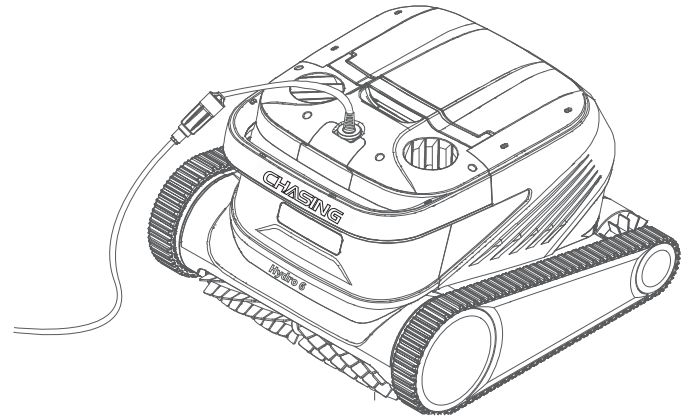

CHASING

V1.1

Table of Contents

EN

Disclaimer	02
Main Components	03
Cleaner	03
Control Box	04
Nylon Mesh Filter Panel	04
Precautions	04
Connection and Operation	05
Pre-cleaning Preparation	05
Control Box	07
Cleaner Indicator	07
After Cleaning	08
APP	09
Download CHASING GO3 APP	09
Bluetooth Connection	09
Remote Control	10
Home	11
Schedule	12
Manual	12
My Profile	12
Routine Maintenance	13
Clean the Filter Basket	13
Filter Panel Replacement	14
Storage	15
Fault Information	15
Product Specifications	16
Product Registration	16
Warranty	17

Disclaimer

EN

Before using the CHASING Hydro 6, please read this disclaimer carefully. By using this product, you are deemed to have read, understood, and accepted all of the contents of this disclaimer.

CHASING and The POPS Group Pty Ltd will not be liable for any personal injury or property loss (including direct or indirect loss) arising from the following circumstances when this product is in use:

1. Any damage resulting from operation while the operator is in poor physical or mental condition.
2. Any personal injury or property loss intentionally caused by the operator.
3. Any damage arising from accidents.
4. Any loss resulting from failure to assemble or operate this product in accordance with the instructions in this Manual.
5. Any other damage caused by improper operation of the Cleaner due to self-modification or replacement of accessories or parts that are not manufactured by CHASING.
6. Any damage caused by using products not manufactured by CHASING, or by using products that imitate CHASING products.
7. Any damage caused by operational errors or incorrect subjective judgment by the operator.
8. Any performance degradation caused by natural wear, corrosion, wire aging, or other aging-related issues of the Cleaner.
9. Any other losses that do not fall within the scope of CHASING's and The POPS Group Pty Ltd's responsibilities.

Main Components Cleaner

CHASING Hydro 6 is an automatic robotic pool cleaner specifically designed for pool cleaning. It replaces traditional cleaning methods, freeing your hands by automatically cleaning the pool floor, walls, and waterline.

Equipped with CHASING-Clean technology, Hydro 6 is suitable for pools of various shapes, ensuring high cleaning coverage and time efficiency. Its dual-precision filtration system accurately captures a wide range of pool debris and contaminants. With the newly developed CHASING GO3 APP, Hydro 6 delivers a smarter, more convenient, and more cost-effective pool cleaning experience.

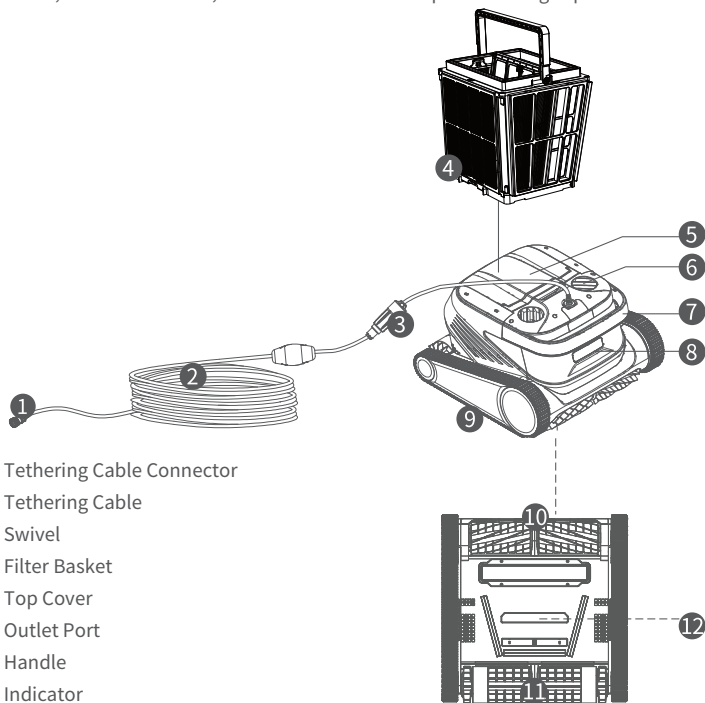

1. Tethering Cable Connector
2. Tethering Cable
3. Swivel
4. Filter Basket
5. Top Cover
6. Outlet Port
7. Handle
8. Indicator
9. Drive Wheel
10. Active Brush
11. Driven Brush
12. Inlet Port

Control Box



1. Power Plug
2. Power Cord
3. Display & Control Panel
4. Tethering Cable Port

Nylon Mesh Filter Panel (1F&2B&3L&4R&5M)

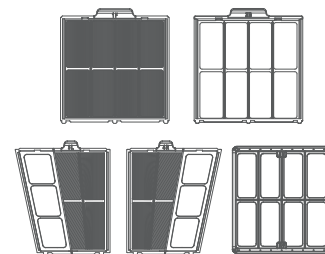

Precautions

- ⚠ Warning: Please read this User Manual carefully and operate the product strictly in accordance with the instructions. The Company shall not be liable for any loss or injury arising from improper operation.
- ⚠ Warning: Children must not operate or approach this product without direct supervision.
- ⚠ Warning: The control box is rated IP54. It must be placed in a dry and shaded location at least 3m away from the pool edge and at least 0.1m above the ground. Avoid exposure to direct sunlight. The control box must be reliably grounded and connected to a circuit equipped with a Ground Fault Circuit Interrupter (GFCI). The GFCI must be tested for proper operation before each use.
- ⚠ Warning: This product may only be disassembled or serviced by authorised and trained technicians of the dealer. Unauthorised repair, modification, or replacement with non-CHASING parts will void the warranty and may cause personal injury.
- ⚠ Warning: The Cleaner is designed for use only in swimming pool water. Do not operate it in any other working environment. No person is allowed to enter the pool while the Cleaner is operating.

- ⚠ Warning: Do not touch any rotating components directly with your hands while the Cleaner is operating.

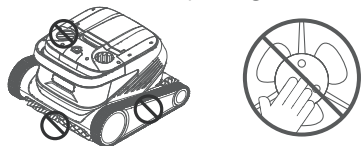

- ⚠ Warning: When putting the Cleaner into or removing it from the water, always hold the handle. Do not lift the Cleaner by the tethering cable.

- ⚠ Warning: Do not operate this product in pool water that contains liquid flocculants or other clarifying chemicals, as such substances may clog or damage the Cleaner's filtration components.

- ⚠ Warning: Please operate the Cleaner only within the following specified environmental conditions:

Operating Depth	0.8-5m
pH	7.0-7.8
Chlorine	Max. 4 ppm

Operating Temperature	10-35°C
Salt	Max. 5,000 ppm

- ⚠ Warning: Operating the Cleaner or the control box outside the specified temperature range, or exposing them to prolonged and intense sunlight, may trigger the over-temperature protection and cause automatic shutdown. Severe cases may result in permanent damage to the product.

Connection and Operation

1 Pre-cleaning Preparation

1.1. The Control Box must be placed in a dry and cool area at least 3 meters away from the pool edge and kept away from direct sunlight.



1.2. Straighten and lay out the tether cable, then insert one end of the tether cable into the port on the right side of the control box and securely tighten the locking nut.

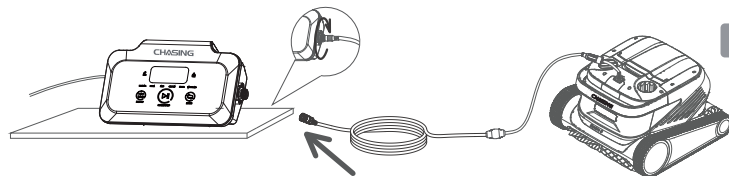

- ⚠ Note: Place the control box on a table or other elevated platform.

1.3. Hold the Cleaner by its handle and slowly lower it into the water. Wait until the Cleaner is fully submerged and no more air bubbles are released. Make sure the tether cable is free of knots and not entangled with any obstacles.

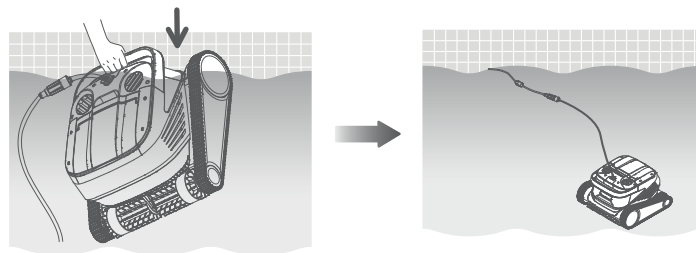

- ⚠ Note: Ensure that an appropriate length of tether cable is placed into the water, allowing the Cleaner to reach all areas of the pool. If the tether cable in the water is too short, the Cleaner may tilt upward or fail to complete cleaning.

Note: The Cleaner is equipped with a water-detection sensor. It will not start unless it is placed in water.

1.4. ① Plug the power cord on the left side of the control box into a power supply (AC 100–240 V). ② The yellow indicator of the START/STOP button on the control box will remain steadily lit, and the Cleaner will enter standby mode.

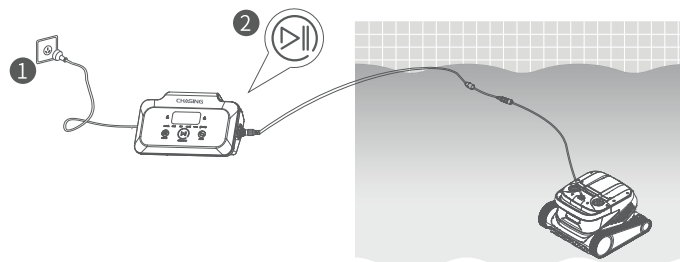

2 Control Box

2.1. You can perform basic operations on the Cleaner using the control box (more functions are available through the APP). After selecting the desired mode, press START/STOP to begin automatic pool cleaning.

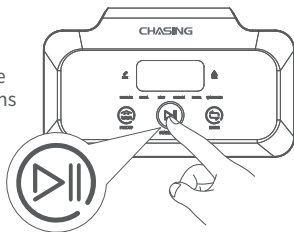

2.2. Interface Functions and Indicator

	Icon	Function	Description	LED Status
Button		Start/Stop	Short press: Start/Pause Long press: Stop	Steady yellow: Cleaning stopped Flashing green : Cleaning paused Steady green: Cleaning in progress Steady red: Control box fault Flashing red: Cleaner main unit fault
		Retrieval	Short press: Enter one-touch retrieval mode	LED solid on: Retrieval mode active
		Mode switching	Short press: Switch cleaning mode (Custom mode can be configured in the APP)	LED solid on: Power connected
Indicator		LINK	The control box is linked	LED flashing: Mobile phone/tablet is linking with the control box LED solid on: The Cleaner successfully recognised by the APP
		Error	The Cleaner & control box fault indicator	LED flashing: A fault condition is detected
	REGULAR	Standard mode	2 hours; floor, wall, water line	When a mode is selected, the corresponding mode indicator will remain steadily lit.
	ULTRA	Enhanced mode	3 hours; floor, wall, water line	
	FAST	Fast mode	1 hour; floor, wall, water line	
	CUSTOM	Custom mode	Configure in the APP	
	FLOOR	Floor mode	2 hours; floor	
	WATERLINE	Waterline mode	2 hours; floor, water line	
Countdown display		Cleaning countdown	Displays the remaining cleaning time	/
Control Box Error Codes	E:00 Communication error between control box and main unit		E:01 Control box power voltage abnormal	E:03 Gyroscope failure
	E:02 Accelerometer failure		E:15 Left drive motor failure or stall	E:25 Right drive motor failure or stall
	E:35 All drive motors failure or stall		E:16 Left pump motor failure or stall	E:26 Right pump motor failure or stall
	E:36 All pump motors failure or stall			

* If no operation is detected for 3 minutes, the indicator lights will enter sleep mode and turn off (only the Start/Stop button remains lit). Press any button to wake up the display. No button function will be activated until the indicators are fully awakened.

3 Cleaner Indicator

LED Status	Description
Flowing white	Self-checking
Steady yellow	Standby in water
Steady orange	Not in water
Steady green	Paused
Flowing green	Cleaning in progress
Flowing yellow	Motor stall alert
Flashing red	Cleaner fault
Flowing cyan	Filter basket clogged reminder

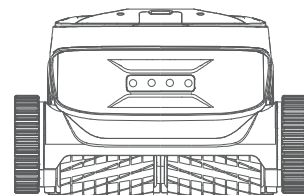

4 After Cleaning

Method 1:

1. Press the “Pick-up” button on the control box or in the APP.

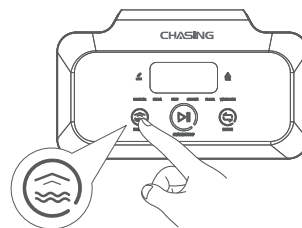

Control Box

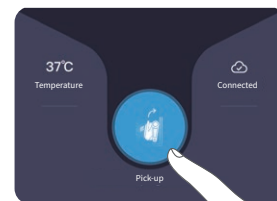

APP

2. Wait for the Cleaner to automatically move to the pool waterline.
3. Hold the Cleaner's handle to lift it out of the water, and keep it above the water surface for 10-20 seconds to allow the internal water to drain.

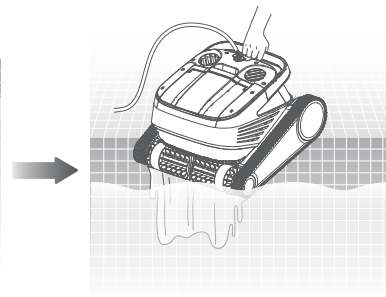
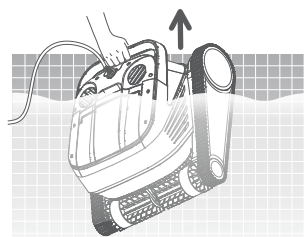

Method 2:

1. Stop the Cleaner.
2. Gently pull the tether cable to guide the Cleaner slowly toward the pool edge.
3. Hold the Cleaner's handle to lift it out of the water, and keep it above the water surface for 10–20 seconds to allow the internal water to drain.

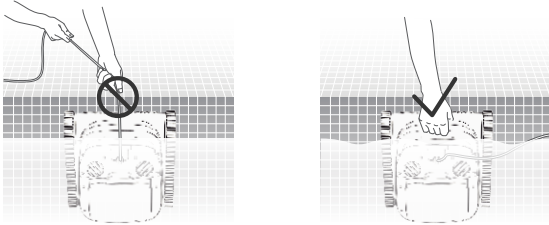

⚠ Note: Do not pull the tethering cable while the Cleaner is on the water surface to avoid breakage or damage.

APP

① Download CHASING GO3 APP

CHASING GO3 APP
(Compatible with iOS 11.0 / Android 7.0 and later) Scan the QR code or visit the iOS APP Store / CHASING official website to download the APP.



② Bluetooth Connection

1. On the “Device Selection” page, tap “CHASING Hydro 6”.
2. Tap “To Connect”.

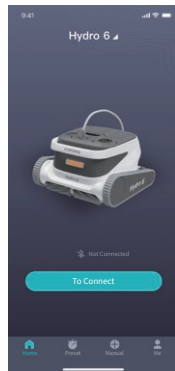

3. When a new device is detected, tap it to connect. After a successful connection, you will be directed to the “Cleaning” page.

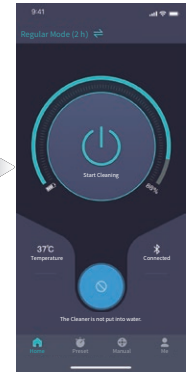
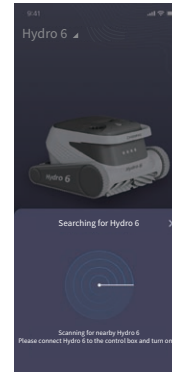

③ Remote Control

1. To use the “Remote Control” function, please register and log in to your CHASING account first.

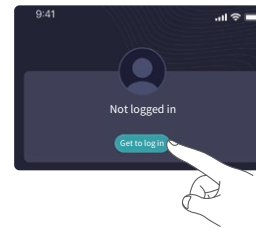

2. On the “Cloud Service” screen, follow the on-screen instructions to connect the Cleaner to the network. Once the network connection is successful, the Remote Control function will be available.

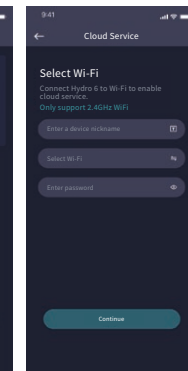
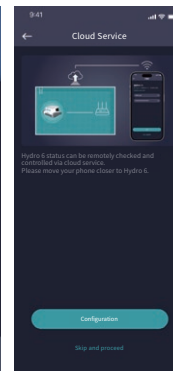
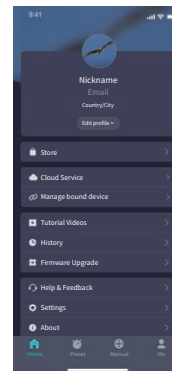

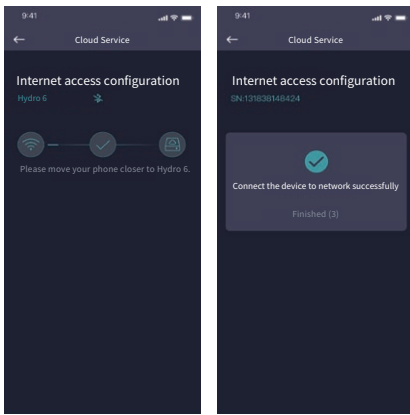

3. You can unbind the current device and add new devices through "Manage bound device"

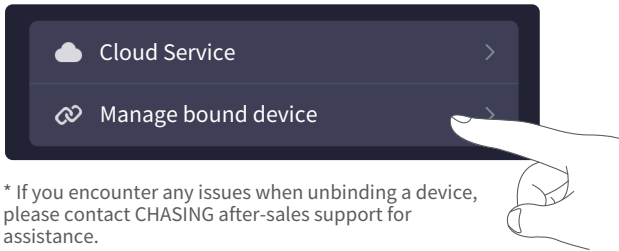

* If you encounter any issues when unbinding a device, please contact CHASING after-sales support for assistance.

4 Home

When the Cleaner is in standby mode and placed in the pool, a preset cleaning schedule can be created to enable unattended operation.

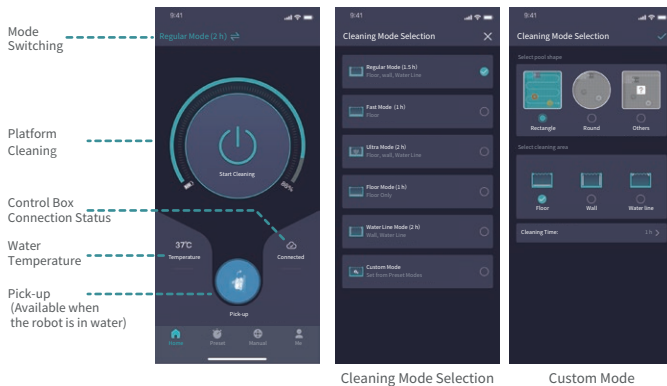

Cleaning Mode Selection

Custom Mode

5 Schedule

When the Cleaner is in standby mode and placed in the pool, a preset cleaning schedule can be created to enable unattended operation.

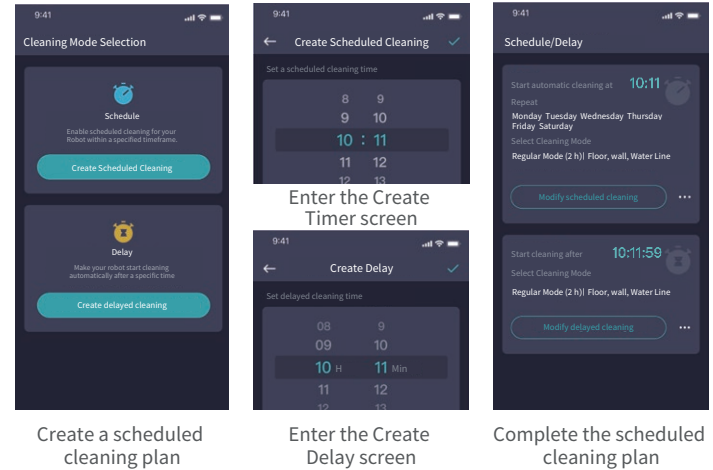

6 Manual Mode

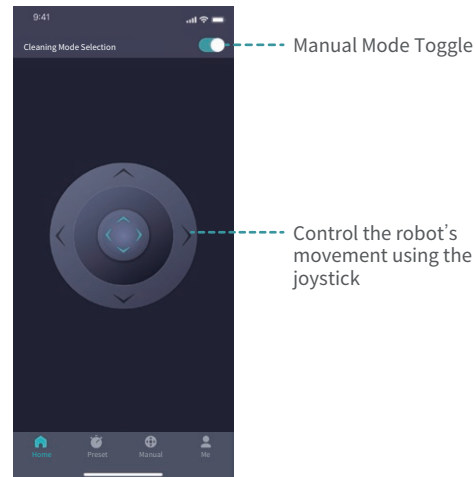

7 My Profile

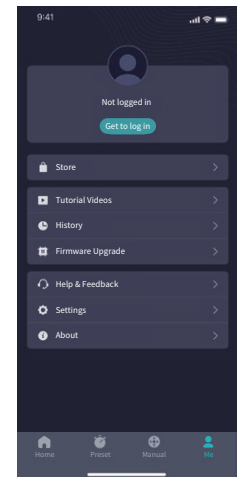

Routine Maintenance

EN

1 Clean the Filter Basket

1.1. Open the robot's top cover and remove the filter basket.

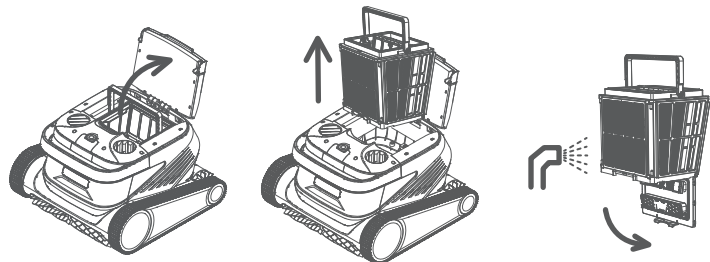

1.2. Disassemble the filter panels in sequence as shown in Figure 2.1.

1.3. Rinse the inside and outside of the filter basket using a water spray.

1.4. After cleaning, reinstall the filter basket into the Cleaner.

▲ Note: Disconnect the Cleaner from the power supply before cleaning. Clean the filter basket after each use to maintain optimal cleaning performance.

2 Filter Panel Replacement

2.1. Removal: Hold the filter basket and remove the filter panels upward in the following order: 5M → 1F → 2B → 3L → 4R.

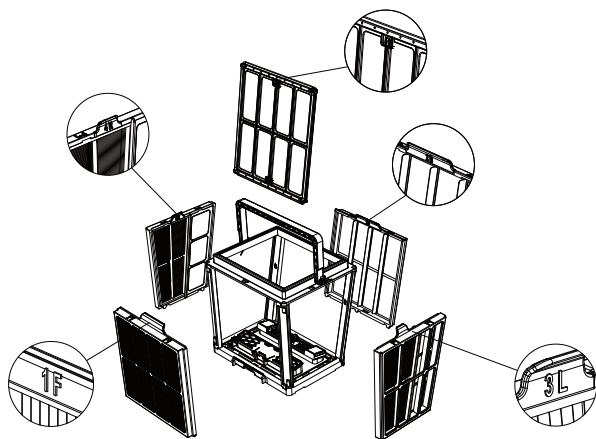

2.2. Installation: Insert the new filter plates into the filter basket in the order of 4R → 3L → 2B → 1F → 5M to complete the filter replacement.

EN

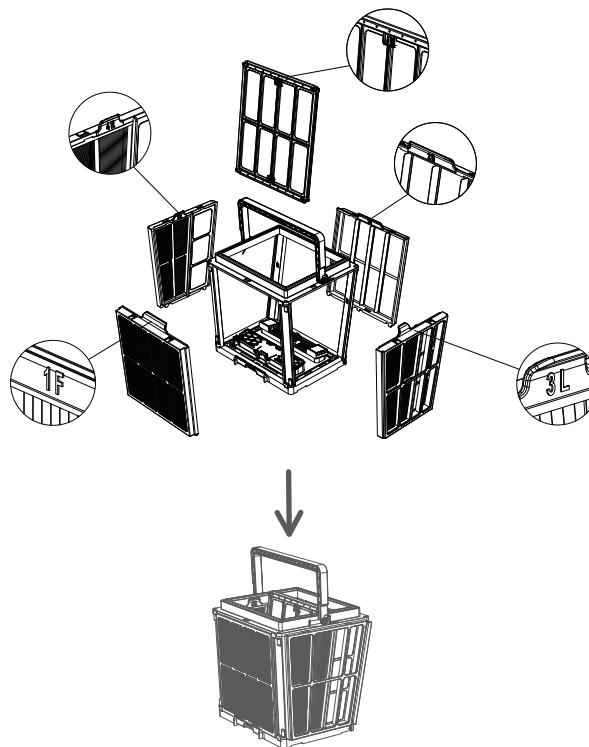

▲ Note: The ultra-fine filter panels are consumable parts designed to capture finer debris. To maintain optimal cleaning performance, it is recommended to replace the ultra-fine filter panels at least once every three months.

③ Storage

If the Cleaner will not be used for an extended period, please follow the steps below:

1. Thoroughly clean the filter basket and filter panels, and reinstall them into the Cleaner.
2. Ensure that no water remains inside the Cleaner.
3. Neatly coil the tethering cable and ensure it is not knotted.
4. Store the Cleaner indoors in a cool, dry place at a temperature between 5–45°C.

Fault Information

Faults	Possible Causes	Troubleshooting
The tethering cable is knotted	The tethering cable is not fully straightened	Unplug the power cord of the power control box and reorganise the tethering cable
	There are obstacles in the pool	Remove the obstacles
The Cleaner is not starting	The Cleaner has been operating for an extended period	Manually straighten and arrange the tethering cable
	The power cord is not securely plugged in	Check whether the wall outlet has voltage
	The power cord is not plugged in properly	Plug in the power cord securely
	The tethering cable is not properly connected	Check whether both ends of the tethering cable are properly connected
	The track is obstructed by a foreign object	Check whether the track is obstructed and remove any foreign object
	The track has come off	Reinstall the track onto the drive wheel
	The Cleaner has not been placed in the water	Place the Cleaner into the water
The Cleaner or power control box is electrically damaged	The Cleaner or power control box is electrically damaged	Check the error code and contact the after-sales dealer
	The filter basket is clogged	Clean the filter basket
The Cleaner moves but fails to clean the pool effectively	The impeller is obstructed by a foreign object	Check whether the impeller is obstructed and remove any foreign object
	The filter basket is clogged	Clean the filter basket
The Cleaner cannot climb walls	The impeller is obstructed by a foreign object	Check whether the impeller is obstructed and remove any foreign object
	The water temperature or pH value is out of range	Use the Cleaner in a pool that meets the required temperature and pH conditions
	Algae are present on the pool walls	Check the chemical balance of the water and scrub the walls
	The control box is positioned incorrectly	Position the control box correctly to ensure the Cleaner can reach all areas of the pool
The Cleaner only cleans a portion of the pool	The tethering cable is insufficient in length	Unplug the power cord of the power control box and reorganise the tethering cable
	The filter basket is clogged	Clean the filter basket
	There are obstacles in the pool	Remove the obstacles

Product Specifications

Cleaner Dimensions	485 x 475 x 342 mm	Moving Speed	15 m/min
Cleaner Weight	12.5 kg (excluding cable)	Cleaner Protection Rating	IP68
Control Box Dimensions	352 × 82 × 211 mm	Control Box Protection Rating	IP54
Control Box Weight	2.3 kg (excluding cable)	Anti-tangle Tether Cable	Supported
Filtering Accuracy	Ultra-fine	Number of Active Brushes	2
Cable Length	18 m / 25 m / 30 m	Pumps	2
Rated Input Voltage	AC 100–240 V, 50–60 Hz	Drive Motors	2
Rated Operating Voltage	DC 24 V	APP	Supported
Power	Average Input Power: 250 W	Scheduled Start	Supported
	Maximum Input Power: 320 W	Manual Mode	Supported
Operating Depth	0.8–5 m	WATER TEMPERATURE DISPLAY	Supported
Max. Pool Length	Up to 15 m	Operating Temperature	5–35°C
Cleaning Zones	Floor, wall, water line	Storage Temperature	5–45°C
		Cloud Service	Supported

Product Registration

Please register your product online at www.poolpro.com.au/product-registration.

CHASING

The contents of this manual are subject to change without prior notice.